

# USER MANUAL

## ANTI-LIGATURE Lead Free Brass

- **AVLF0025** - Hob or Wall Mounted Lead Free DZR Brass Control Valve w/ Anti-Ligature and Control Valves
- **AVLF1000** - Hob or Wall Mounted Lead Free DZR Brass Outlet w/ Anti-Ligature Outlet
- **AVLF0075** - Wall Mounted Lead Free DZR Brass Shower Set w/ Fixed Anti Vandal Showerhead and Control Valves
- **AVLF0001** - Hob or Wall Mounted Lead Free DZR Brass Basin Set w/ Anti Ligature Outlet and Control Valves
- **TFTLF6000** - Lead Free DZR Brass Wall Mounted Spray Showerhead



Table of Contents	
Scope of Use	2
Technical Information	3
Product Images & Technical Drawings	4
Installation Steps	7
Troubleshooting	13
Water Quality	14
Responsibly Sourced	14
Cleaning & Maintenance	15



# USER MANUAL

---

## Scope of Use

Installation of all products should adhere to the manufacturer's guidelines, as well as comply with PCA, AS/NZS3500 standards, and any other relevant regulatory provisions. This product range complies with the Lead Free requirements of the National Construction Code Volume Three.

---

- **Installation:** Refer to the installation instructions included within this manual
- **Water quality:** Must prevent any debris from entering the waterway
- **Suitable for indoor use only**
- **Temperature recommendation:**
  - Working Temperature: 5°C - 60°C
- **Mounting:** Bench or wall mounted installation

## Technical Information

<b>Material</b>	<ul style="list-style-type: none"> <li>• Body: Lead Free DZR Brass</li> <li>• Handle: Brass (AVLF0001, AVLF0025, AVLF0075 &amp; AVLF1000)</li> </ul>
<b>Cartridge</b>	<ul style="list-style-type: none"> <li>• Ceramic Disc (Quarter Turn): AVLF0001, AVLF0025 &amp; AVLF0075</li> <li>• Timed Flow (Hydraulic): TFTLF6000</li> <li>• N/A: AVLF1000</li> </ul>
<b>Cartridge Size</b>	<ul style="list-style-type: none"> <li>• 5/8": AVLF0001, AVLF0025 &amp; AVLF0075</li> <li>• 15mm: TFTLF6000</li> <li>• N/A: AVLF1000</li> </ul>
<b>Inlet</b>	<ul style="list-style-type: none"> <li>• 15mm: AVLF0001, AVLF0025, AVLF0075 &amp; TFTLF6000</li> <li>• 15 mm Male: AVLF1000</li> </ul>
<b>Flow Style</b>	<ul style="list-style-type: none"> <li>• Free Flow: AVLF0001, AVLF0025 &amp; AVLF1000</li> <li>• Fixed Shower Spray: AVLF0075</li> <li>• Spray Flow: TFTLF6000</li> </ul>
<b>Working Pressure</b>	<ul style="list-style-type: none"> <li>• 50kPa-500kPa: AVLF0001, AVLF0025, AVLF0075 &amp; AVLF1000</li> <li>• 150kPa-500kPa: TFTLF6000</li> </ul>
<b>Manufacturers Recommended Pressure</b>	350 kPa
<b>Working Temperature</b>	<ul style="list-style-type: none"> <li>• 5°C - 60°C: AVLF0001, AVLF0025, AVLF0075 &amp; AVLF1000</li> <li>• 5°C - 50°C: TFTLF6000</li> </ul>
<b>Finish</b>	<ul style="list-style-type: none"> <li>• Chrome Plated: AVLF0001, AVLF0025, AVLF0075 &amp; AVLF1000</li> </ul>
<b>Servicing</b>	Preventative Maintenance

# USER MANUAL

## Product Images & Technical Drawings

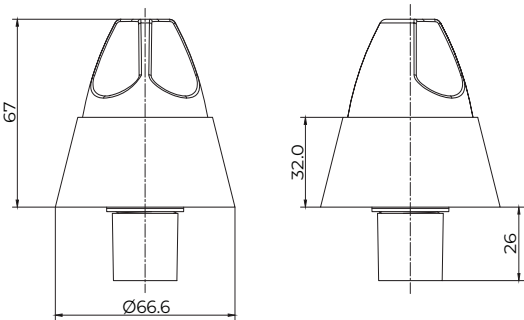

### AVLF0025

Hob or Wall Mounted Lead Free DZR Brass Control Valve w/ Anti-Ligature and Control Valves

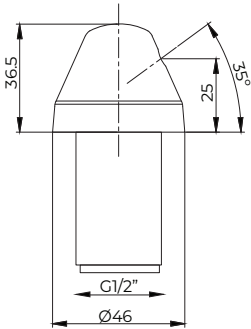

### AVLF1000

Hob or Wall Mounted Lead Free DZR Brass Outlet w/ Anti-Ligature Outlet

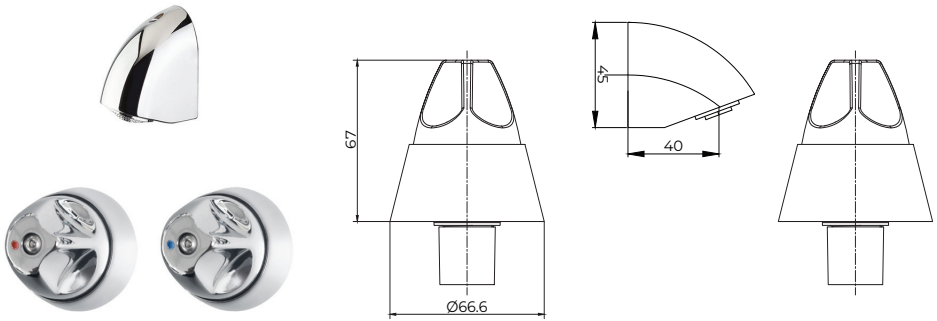

### AVLF0075

Wall Mounted Lead Free DZR Brass Shower Set w/ Fixed Anti Vandal Showerhead and Control Valves

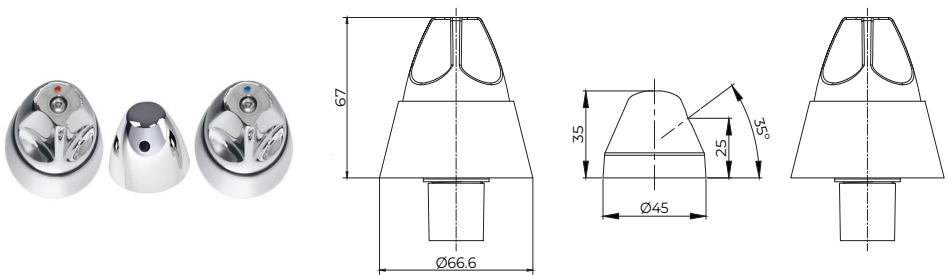

### AVLF0001

Hob or Wall Mounted Lead Free DZR Brass Basin Set w/ Anti Ligature Outlet and Control Valves

# USER MANUAL

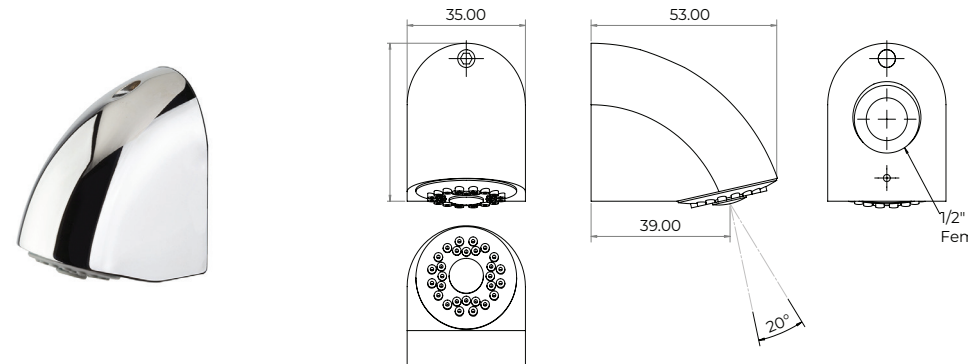

**TFTLF6000**  
Lead Free DZR Brass Wall Mounted Spray Showerhead

Note: Dimensions are provided as a guide and are subject to manufacturing tolerances.

# Installation Steps

## AVLF0001 MOUNTING INSTRUCTIONS

### Basin Outlet

**Step 1.** Allow a 25mm cut-out hole to fit the basin outlet. Drill a 3mm hole to fit the anti-vandal pin. Ensure outlet position. This should be fixed to prevent movement.

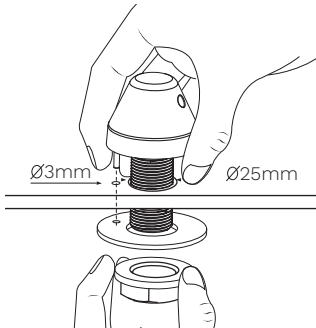

**Step 2.** Fix the washer and tighten the fixing nut.

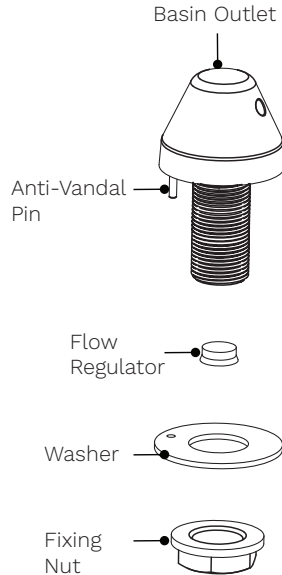

### Handles

**Step 1.** Remove the handle and unscrew the cover flange (4) from the main body of the cartridge (1). Also, unscrew the adjustable locknut (3) from the cartridge body. Ensure the fibre washer (2) is in place.

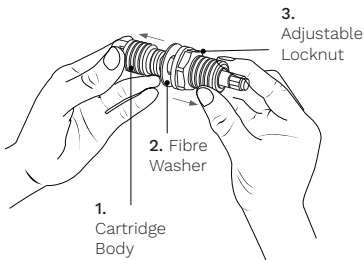

**Step 2.** Screw the cartridge body (1) into the thread until it touches the seat.

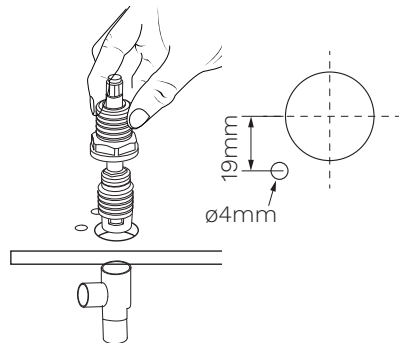

Step 3. Screw the adjustable locknut (3) until it reaches the breech (to prevent the cartridge being overtightened). Unscrew the fixing screw and replace the cover flange (4).

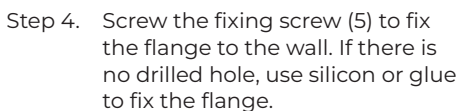

- Step 5. Screw the handle (6) in the desired position with the provided security Allen key and screw (7).
- Step 6. Fit the desired indicator into the handle.

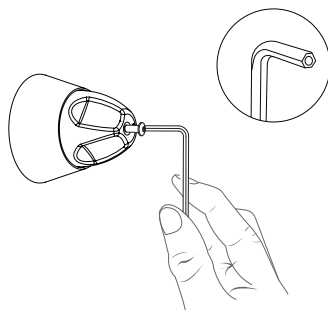

### General Installation

The diagram illustrates the general installation of the water filter unit. It shows the disassembly of the filter head, which is done by removing a screw and lifting the head off the body. The bottom part of the diagram shows the unit's connection to a water supply line. A tee fitting is installed on the supply line, with a ball valve on one side and a cartridge on the other. A hose connects the tee fitting to the filter body. Labels include: Screw, Colour Indicator, Ball Valve, Hose, Tee Fitting, Body, and Cartridge.



## AVLF0025 INSTALLATION

- Step 1.** Remove the handle and unscrew the cover flange (4) from the main body of the cartridge (1). Also, unscrew the adjustable locknut (3) from the cartridge body. Ensure the fibre washer (2) is in place.

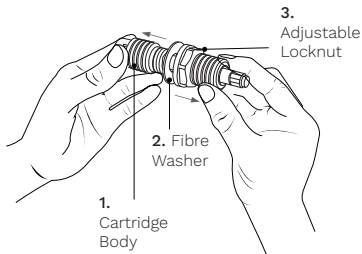

- Step 2.** Screw the cartridge body (1) into the thread until it touches the seat.

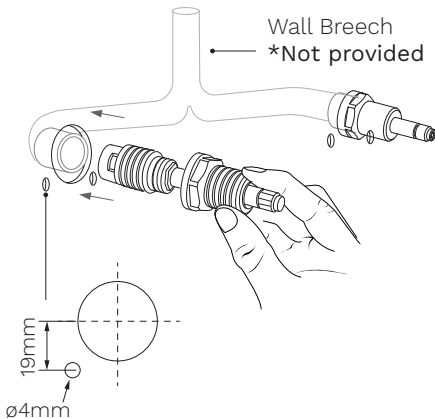

- Step 3.** Screw the adjustable locknut (3) until it reaches the breech (to prevent the cartridge being overtightened). Unscrew the fixing screw and replace the cover flange (4).

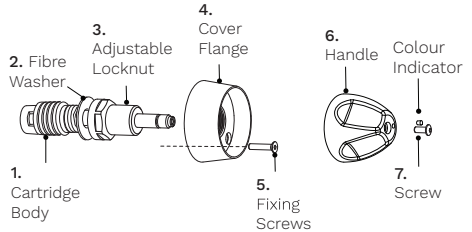

- Step 4.** Tighten the fixing screw (5) to fix the flange to the wall. If there is no drilled hole, use silicon or glue to fix the flange.

- Step 5.** Screw the handle (6) in the desired position with the provided security Allen key and screw (7).

- Step 6.** Fit the desired indicator into the handle.

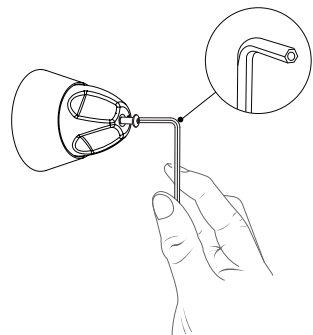

# USER MANUAL

## AVLF0075 MOUNTING INSTRUCTIONS

### Shower Head

Step 1. Install the flow regulator first with the indicated side facing up. Then install the strainer.

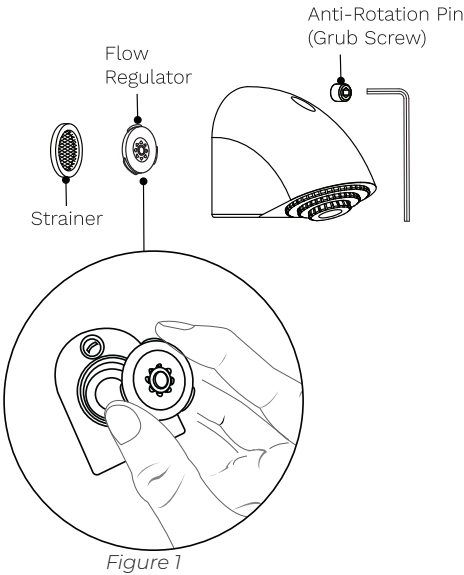

### Important Information

Ensure the flow regulator is installed with the indicated side facing up. (Figure 1)

Step 2. Drill a 6mm hole to fit the anti-vandal pin. This should be fixed to prevent the movement of the outlet.

Step 3. Screw the showerhead to the G1/2" male thread protruding from the wall thread tape.

Follow the recommended height for mounting the shower head. (Figure 2)

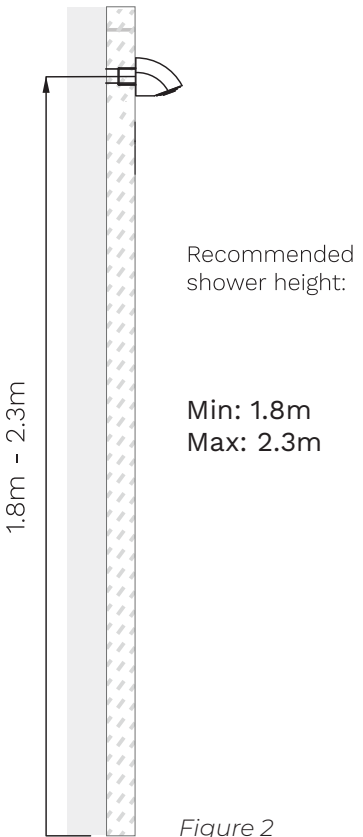

## Handles

**Step 1.** Remove the handle and unscrew the cover flange (4) from the main body of the cartridge (1). Also, unscrew the adjustable locknut (3) from the cartridge body. Ensure the fibre washer (2) is in place.

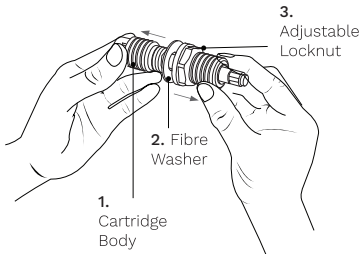

**Step 2.** Screw the cartridge body (1) into the thread until it touches the seat.

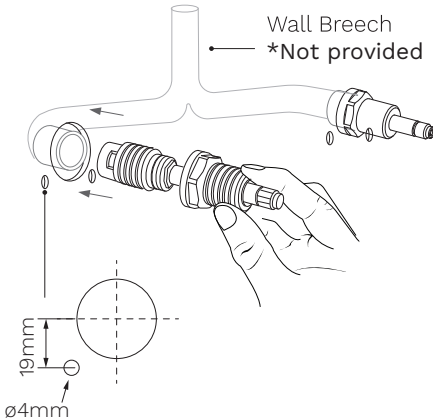

**Step 3.** Screw the adjustable locknut (3) until it reaches the breech (to prevent the cartridge being overtightened). Unscrew the fixing screw and replace the cover flange (4).

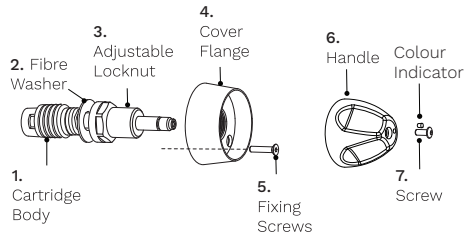

**Step 4.** Tighten the fixing screw (5) to fix the flange to the wall. If there is no drilled hole, use silicon or glue to fix the flange.

**Step 5.** Screw the handle (6) in the desired position with the provided security Allen key and screw (7).

**Step 6.** Fit the desired indicator into the handle.

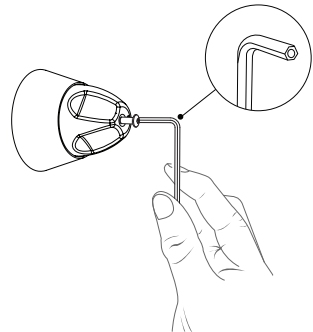

# USER MANUAL

## TFTLF6000 MOUNTING INSTRUCTIONS

### Shower Head

Step 1. Install the flow regulator first with the indicated side facing up. Then install the strainer.

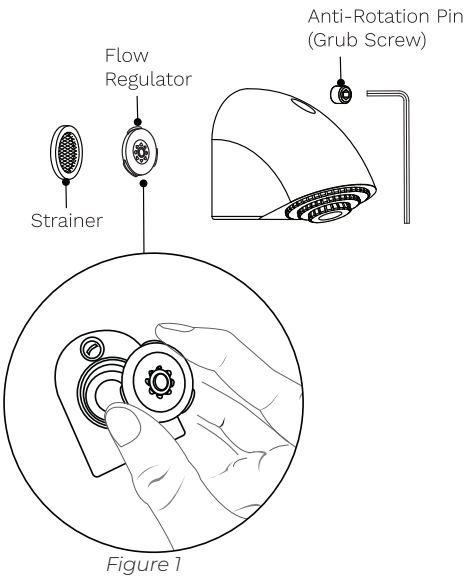

### Important Information

Ensure the flow regulator is installed with the indicated side facing up. (Figure 1)

Step 2. Drill a 6mm hole to fit the anti-vandal pin. This should be fixed to prevent the movement of the outlet.

Step 3. Screw the showerhead to the G1/2" male thread protruding from the wall thread tape.

Follow the recommended height for mounting the shower head. (Figure 2)

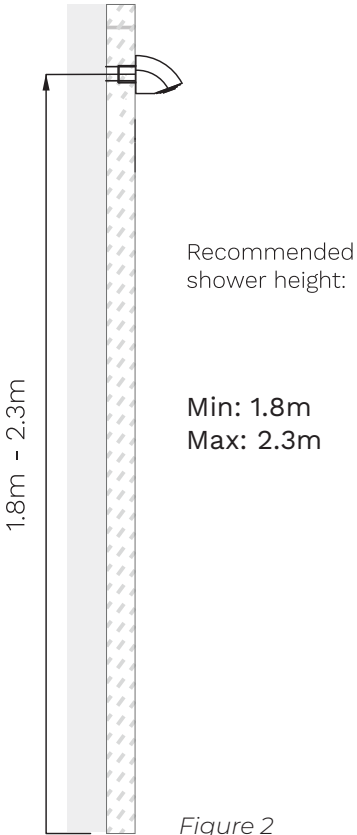

## Troubleshooting

Problem	Cause	How to Fix
Water not shutting off	<ul style="list-style-type: none"> <li>Cartridge not set correctly</li> </ul>	<ul style="list-style-type: none"> <li>Turn off water supply</li> <li>Remove handles and undo the cartridge lock nut</li> <li>Tighten the cartridge to ensure cartridge is against the seat</li> </ul>
No water from basin outlet	<ul style="list-style-type: none"> <li>Ball valve</li> </ul>	<ul style="list-style-type: none"> <li>Ensure the ball valve is in the open position</li> </ul>
Shower head not performing correctly	<ul style="list-style-type: none"> <li>Shower head blockage</li> </ul>	<ul style="list-style-type: none"> <li>Remove shower head and ensure there is no debris or thread tape blocking the waterways</li> <li>Ensure strainer is in place and the flow regulator facing the correct direction</li> </ul>
Time flow control valve not activating	<ul style="list-style-type: none"> <li>Push button assembly</li> </ul>	<ul style="list-style-type: none"> <li>Ensure the cartridge length has been adjusted correctly to activate the valve</li> </ul>
Low water flow from the flow control valve	<ul style="list-style-type: none"> <li>Flexi hose</li> </ul>	<ul style="list-style-type: none"> <li>Ensure the flexi hoses are not twisted or kinked.</li> </ul>

# USER MANUAL

## Water Quality

### Maximum chloride Cl- level Guidelines in plumbing systems

	Cold Water	Hot Water
Grade 304L	200	50
Grade 316L	1000	250

When materials may be used in either hot or cold water lines, the guidelines for hot water should be used.

Within these guidelines at ambient temperatures and provided the pH >~6, any negative effect to stainless steel will be unlikely.

Note: Chlorides in water - where the density of the solvent (water) is 1 (which it is to within 0.1% at ambient temperatures), then mg/L = ppm.

For brass products, please ensure the chlorine and chloramines levels are not more than 0.4 ppm.  
Please ensure that the water quality supplied to the fixtures meets safe drinking standards to prevent potential staining of the product.

### Chlorine guidelines (not to be confused with chloride)

- 304L suitable for chlorine levels up to 2ppm.
- 316L suitable for chlorine levels up to 5ppm.
- Short term dosing, for example 25-50ppm, for sterilisation purposes of 24-48 hours acceptable if effectively flushed through afterwards.
- Sterilisation is essential during commissioning of potable water systems.

Reference: <https://www.assda.asn.au/component/content/article?id=271:chlorine-and-chloride--same-element,-very-different-effect>

## Responsibly Sourced



### Reduce Carbon Footprint

GENTEC is rejuvenating the product- no power, less maintenance and longer life.

### Rejuvenation Program

To learn more about the rejuvenation program, please contact our customer service at [info@gentecaustralia.com.au](mailto:info@gentecaustralia.com.au) for more information.

### Ethically and Environmentally Sourced

Please refer to GENTEC Business Ethics & Ethical Sourcing Policy at <https://gentecaustralia.com.au/terms-and-conditions/>

## Cleaning & Maintenance

To minimise downtime and maximise the functional life of the product, GENTEC recommends servicing your product at least every 12 months, under heavy use may need to be checked and serviced more often.

- The product must be handled carefully to avoid causing any physical damage.
- Use the product at least once every week to ensure all parts are kept lubricated and functioning properly.
- Service the product at least once a year to avoid any product failures - The service timeline provided is based on normal use. More frequent servicing may be required for heavy usage.
- A working pressure of 350kPa is highly recommended to ensure the maximum up-time of the product.
- Regularly clean the product with a soft cloth with warm soapy water, wash off with warm water and dry off with a soft dry cloth, paying attention to removing the dust and contamination in the bends and joints is highly recommended.
- Abrasives, hard clothes, strong acids, and bleaches must be avoided when cleaning all GENTEC products.
- Installation must be completed by a qualified and licenced plumber and adhere to AS/NZS3500 and manufacturer's recommendations.

Parts	Product Name
CLLF9001H	CLEANLINE - Lead Free Brass Cartridge Recessed Qtr turn - Anti Clockwise to operate
AVLF0025F	ANTI VANDAL - Lead Free Brass Flange only
AVLF0025H	ANTI VANDAL - Lead Free Handle/Screw/Button only
AVINDKIT01	ANTI VANDAL - Indicator Kit Complete
FRW6	Flow Regulator Flat Washer G1/2" - 6lpm Black (suit TFTLF6000)
TFT9070	FLOSTOP - Mesh Strainer only (suit TFTLF6000)



A: Unit 6, 20-28 Ricketty St,  
Mascot, Sydney, NSW 2020

E: [info@gentecaustralia.com.au](mailto:info@gentecaustralia.com.au)

P: +612 9319 4422

F: +612 8088 7635

Gentec products come with a Manufacturer's Warranty. To ensure the validity of this warranty, Gentec products must be installed following the provided installation instructions and adhering to AS 3500, NCC Volume Three, relevant Australian Standards, and any local authority requirements applicable to the product. Additionally, water and electrical supply conditions must meet the appropriate national and/or state standards. Non-compliance with these provisions may void the warranty and impact product performance.

Note: The information provided is only a guide, actual product may differ. The information here should not be relied on without clarification with Gentec. Gentec reserves the right to make design changes at any time without notification.

\*Subject to terms and conditions. For detailed warranty information, installation compliance, maintenance and cleaning guidelines, and other relevant details, please visit <https://gentecaustralia.com.au>

[gentecaustralia.com.au](https://gentecaustralia.com.au)